

1 Glue the templates sheet to **medium weight card**

Print the window sheets on to **transparency (OHP) film** as required

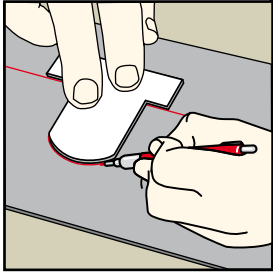

2 Mark a baseline on to the wall, trace around the supplied templates and carefully cut out the window openings.

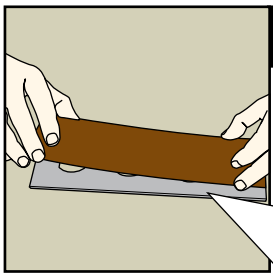

3 Apply a thin even coat of glue to the wall, then squarely position your chosen brick paper. Check for bubbles and creases.



A full range of matching brick papers are available from Scalescenes.com

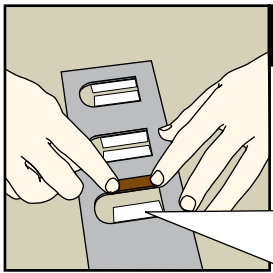

4 Flip the wall over (brick paper down). At each window opening cut down the centre of the brick paper to create flaps. Apply a thin bead of glue along the flaps and fold tightly around the edge of the opening. Check for bubbles and creases.



Wrap & glue

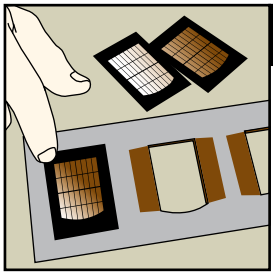

5 Using glue or adhesive tape, position the windows. Turn the wall over and check the windows are sitting squarely within the openings.



The supplied windows could be enhanced using fine styrene strips (such as Evergreen).

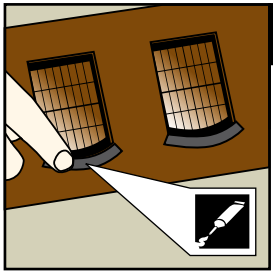

6 Cut out the corresponding arches and glue into position.

7 Apply several light coats of artist's matt spray varnish to the entire model to protect the print surface.



Use small tabs of 'Post it' notes to mask off the windows (matt spray can add an unwanted frosting to the glazing).

Tools required ↓

- Steel ruler
- Modelling knife *[Card blunts knives, replace blade regularly!]*
- Tweezers
- Glue stick *[Ideal for applying printed sheets to card]*
- 'All purpose' clear or PVA adhesive
- CA or 'super glue' *[Ideal for small fiddly elements]*
- Matt spray varnish
- Felt tip pens
- Pencil
- Cutting mat or sheet of thick card
- Damp cloth *[To wipe glue off fingers]*
- Fine sand paper *[To smooth rough edges]*

Arch options ↓

Not to scale

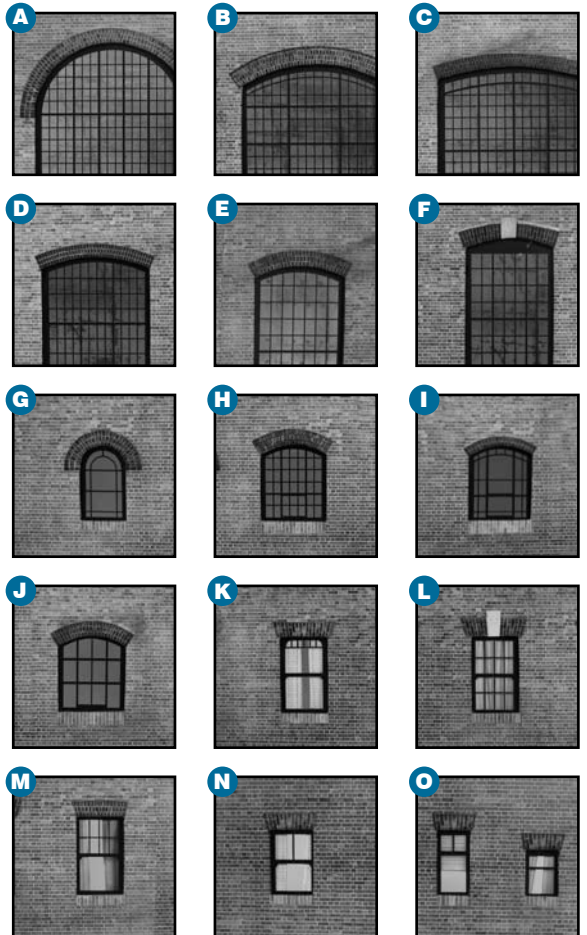

Optional basic weathering → Using a sharp knife scrape a small amount of black and brown artist pastels on to a scrap of card. With some cotton wool softly work very small amounts of the pastel dust into the corners and surface of the structure as required.



Build up thin layers slowly, don't over do it!